

Index File No. T 3 S R 9 W R.D. HeBo County TILLAMOOK Tract or Survey No. # 559 Cor. No. Z-5
 Merid. Will N.F. SIUSLAW State ORE.

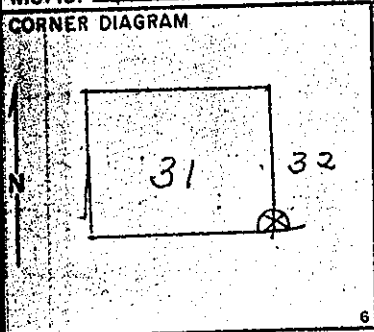

DESCRIBE CORNER MONUMENT FOUND G.L.O. 1880 SET POST AND MKD.:
 A 24" FIR, N. 45° W., 158 LKS.
 A 24" FIR, N. 40° E., 79 LKS.
 A 36" FIR, S. 36° E., 76 LKS.
 A 56" FIR, S. 21° W., 88 LKS.

DESCRIBE BEARING TREES OR OTHER OFFICIAL ACCESSORIES FOUND
 By RECORDS M. WHITMORE, 3-23-59 USFS. FOUND A DEAD FIR SNAG, S. 36° E., 76 LKS. WITH SCRIBE MKS. "T. HSR 9W" SHOWING.

PHOTO IDENTIFICATION DATA
 Photo No. _____
 Filed At. _____
 Object Ident. _____
 Ident. By. _____
 Signature _____
 PLANE COORDINATE POSITION DATA
 State _____ Zone _____
 X _____
 Y _____
 Estab. By. _____
 Agency _____

DESCRIBE CORNER LOCATION RELATIVE TO NEAR-BY FEATURES, ALSO HOW TO REACH CORNER
 HE MARKED 2 NEW BT'S:
 18" FIR, N. 50° E., 3 FT. MKD. S 32 BT.
 39" FIR, N. 54° W., 26 FT. MKD. S 31 BT.
 IN THE PRESENCE OF VIRGIL DONALDSON.

Signature Leonard Whitmore Title Forestry tech Division Timber Headquarters Hebo Date 1-31-69 7100-52 (3/68)



REWITNESS

I SET

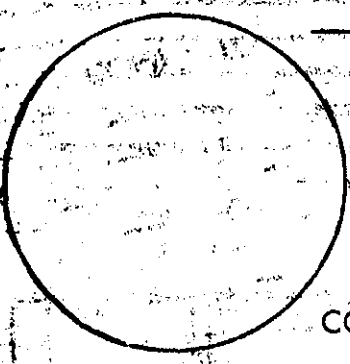

"x"	"x"	" Post	N. W.	feet
" Hat Section			S. E.	
NEW ACCESSORY:				

COMMENTS: Backside of front is blank

IN THE PRESENCE OF: _____

DATE: _____

PHOTO# _____

County corner tag affixed.

TILLAMOOK COUNTY BEM LIPERS TITLE